

LABELING PLATE SNAP-ON OR SELF-ADHESIVE FOR LABEL HOLDER, LABEL SIZE 12.5 X 27MM, LABEL BLACK, LETTERING WHITE, WITH INSCRIPTION: FAULT



Figure similar

product brand name	SIRIUS ACT
Product designation	Commanding and signaling devices
Design of the product	Label

**General technical data:**

Protection class IP	IP66, IP67, IP69(IP69K)
Shock resistance	Category 1, Class B
<ul style="list-style-type: none"> <li>for railway applications acc. to DIN EN 61373</li> </ul>	
Vibration resistance	Category 1, Class B
<ul style="list-style-type: none"> <li>for railway applications acc. to DIN EN 61373</li> </ul>	

**Installation/ mounting/ dimensions:**

Height	12.5 mm
Width	27 mm

**Accessories:**

Material of accessory	Plastic
Mounting type of label	snap on / stick
Marking of the name plate for command devices	Fault
Shape of the name plate for command devices	rectangular
Color of the label	black/white (plate/text)

## Certificates/ approvals:

For use in hazardous locations	Declaration of Conformity	other
--------------------------------	---------------------------	-------

[Herstellereklärung](#)

[Bestätigungen](#)



EG-Konf.

## Further information

### Information- and Downloadcenter (Catalogs, Brochures,...)

<http://www.siemens.com/industrial-controls/catalogs>

### Industry Mall (Online ordering system)

<https://mall.industry.siemens.com/mall/en/en/Catalog/product?mlfb=3SU19000AC160EC0>

### Cax online generator

<http://support.automation.siemens.com/WW/CAXorder/default.aspx?lang=en&mlfb=3SU19000AC160EC0>

### Service&Support (Manuals, Certificates, Characteristics, FAQs,...)

<https://support.industry.siemens.com/cs/ww/en/ps/3SU19000AC160EC0>

### Image database (product images, 2D dimension drawings, 3D models, device circuit diagrams, EPLAN macros, ...)

[http://www.automation.siemens.com/bilddb/cax\\_de.aspx?mlfb=3SU19000AC160EC0&lang=en](http://www.automation.siemens.com/bilddb/cax_de.aspx?mlfb=3SU19000AC160EC0&lang=en)

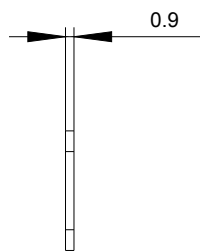
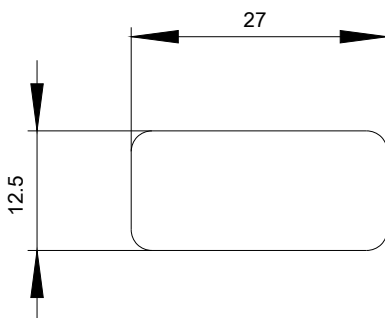

last modified:

18.09.2015