

# Steel Rod Hanger Threaded Rod Anchor System

The Simpson Strong-Tie® steel rod hanger is a one-piece fastening system for suspending 1/4" and 3/8" threaded rod. Vertical rod hangers are designed to suspend threaded rod in overhead applications from steel joists and beams. Horizontal rod hangers are available for applications requiring installation into the side of joists, columns and overhead members. Both rod hangers provide attachment points for use in pipe hanging, fire protection, electrical conduit and cable-tray applications. Recommended for use in dry, interior, non-corrosive environments only.

## Features

- Threaded anchors for rod-hanging applications in steel members
- Suitable to be installed horizontally or vertically in overhead applications
- Self-drilling tip, no predrilling required
- Recommend installation with a 18V cordless drill/driver
- Custom-matched nut driver sets anchor to optimal depth

**Codes:** FM 3058980;  
UL File Ex3605

**Material:** Carbon steel

**Coating:** Zinc plated

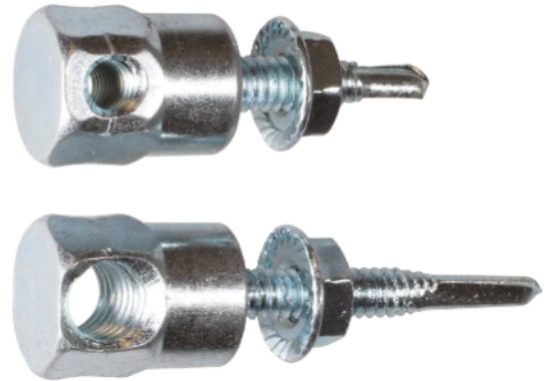

RSH  
Horizontal Steel  
Rod Hangers

## Steel Rod Hangers

Rod Diameter (in.)	Size	Model No.	Drill Point	Application	Steel Thickness Range	Quantity	
						Box	Carton
1/4	1/4" x 1" with nut	RSH25100N	#3	Horizontal	20 ga. – 12 ga.	25	250
1/4	#12–20 x 1 1/2"	RSH25112-5	#5		20 ga. – 1/4"		
3/8	1/4" x 1" with nut	RSH37100N	#3		20 ga. – 12 ga.		
3/8	#12–20 x 1 1/2"	RSH37112N-5	#5		20 ga. – 1/4"		
1/4	1/4" x 1"	RSV25100	#3	Vertical	20 ga. – 12 ga.	25	250
3/8	1/4" x 1" with nut	RSV37100N	#3		20 ga. – 12 ga.		
3/8	1/4" x 1 1/2"	RSV37112	#3		20 ga. – 14 ga.		
3/8	1/4" x 1 1/2" with nut	RSV37112N	#3		20 ga. – 14 ga.		
3/8	#12–20 x 1 1/2"	RSV37112N-5	#5		20 ga. – 1/4"		
3/8	1/4" x 2"	RSV37200	#3		20 ga. – 14 ga.		



RSV  
Vertical Steel  
Rod Hangers

## Nut Driver

Custom-matched nut driver sets the rod hangers to optimal depth every time.

Model No.	Description	Quantity	
		Box	Carton
RND62	Nut driver	10	60



RND62

# Steel Rod Hanger Threaded Rod Anchor System



## Ultimate and Allowable Loads for Vertical Steel Rod Hangers

Model No.	Rod Dia. (in.)	Size (in.)	Loads in Various Steel Thicknesses												UL Listed Steel Thickness Range	FM Listed Steel Thickness Range		
			33 mil (20 ga.)		43 mil (18 ga.)		54 mil (16 ga.)		68 mil (14 ga.)		97 mil (12 ga.)		3/16"				1/4"	
			Ult. (lb.)	Allow. (lb.)	Ult. (lb.)	Allow. (lb.)	Ult. (lb.)	Allow. (lb.)	Ult. (lb.)	Allow. (lb.)	Ult. (lb.)	Allow. (lb.)	Ult. (lb.)	Allow. (lb.)			Ult. (lb.)	Allow. (lb.)
RSV25100	1/4	1/4 x 1	355	130	575	190	880	325	1,110	410	2,050	760	—	—	—	—	—	—
RSV37100N <sup>3</sup>	3/8	1/4 x 1	1,370	505	1,980	730	3,405	1,260	3,890	1,440	3,900	1,440	—	—	—	—	20 ga. – 12 ga.	16 ga. – 12 ga.
RSV37112	3/8	1/4 x 1 1/2	355	130	575	190	880	325	1,110	410	—	—	—	—	—	—	—	—
RSV37112N <sup>3</sup>	3/8	1/4 x 1 1/2	1,370	505	1,980	730	3,405	1,260	3,890	1,440	—	—	—	—	—	—	20 ga. – 14 ga.	16 ga. – 14 ga.
RSV37200	3/8	1/4 x 2	355	130	575	190	880	325	1,110	410	—	—	—	—	—	—	—	—
RSV37112N-5 <sup>3</sup>	3/8	#12–20 x 1 1/2	1,370	505	1,980	730	2,185	730	2,185	730	2,560	940	3,290	1,095	3,290	1,095	20 ga. – 1/4"	16 ga. – 1/4"

Footnotes below apply to both tables.



## Ultimate and Allowable Loads for Horizontal Steel Rod Hangers

Model No.	Rod Dia. (in.)	Size (in.)	Loads in Various Steel Thicknesses												UL Listed Steel Thickness Range	FM Listed Steel Thickness Range		
			33 mil (20 ga.)		43 mil (18 ga.)		54 mil (16 ga.)		68 mil (14 ga.)		97 mil (12 ga.)		3/16"				1/4"	
			Ult. (lb.)	Allow. (lb.)	Ult. (lb.)	Allow. (lb.)	Ult. (lb.)	Allow. (lb.)	Ult. (lb.)	Allow. (lb.)	Ult. (lb.)	Allow. (lb.)	Ult. (lb.)	Allow. (lb.)			Ult. (lb.)	Allow. (lb.)
RSH25112-5	1/4	#12–20 x 1 1/2	420	155	685	255	835	310	930	310	1,240	425	1,270	425	1,350	500	—	—
RSH25100N <sup>3</sup>	1/4	1/4 x 1	1,150	385	1,235	455	1,235	455	1,235	455	1,480	545	—	—	—	—	—	—
RSH37100N <sup>3</sup>	3/8	1/4 x 1	1,575	525	1,865	665	1,865	665	1,865	665	1,865	665	—	—	—	—	18 ga. – 12 ga.	16 ga. – 12 ga.
RSH37112N-5 <sup>3</sup>	3/8	#12–20 x 1 1/2	1,490	550	1,490	550	1,490	550	1,490	550	1,490	550	1,490	550	1,490	550	18 ga. – 1/4"	16 ga. – 1/4"

1. Allowable loads are based on a factor of safety calculated in accordance with AISI S100 Section F1.
2. Mechanical and plumbing design codes may prescribe lower allowable loads. Verify with local codes.
3. Model requires installation with supplied retaining nut.
4. Values are based on steel members with the following minimum yield and tensile strengths:
  - 43 mil (18 ga.) and 33 mil (20 ga.):  $F_y = 33$  ksi and  $F_u = 45$  ksi
  - 54 mil (16 ga.) to 97 mil (12 ga.):  $F_y = 50$  ksi and  $F_u = 65$  ksi
  - 3/16" and 1/4":  $F_y = 36$  ksi and  $F_u = 58$  ksi.
5. Minimum edge distance must be 1" and minimum spacing must be 2".
6. Acceptability of base material deflection due to imposed loads must be investigated separately.

### Horizontal Installation

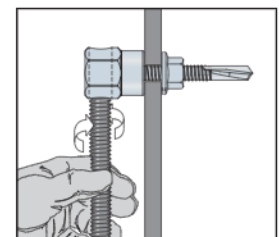
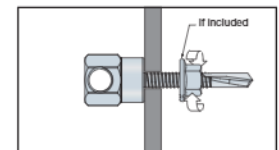
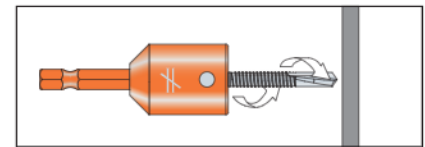
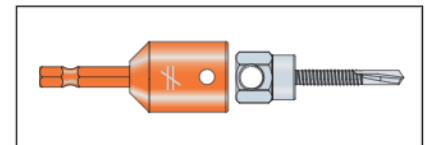

### Vertical Installation

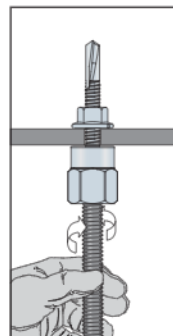
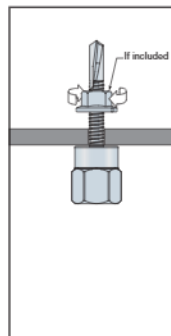
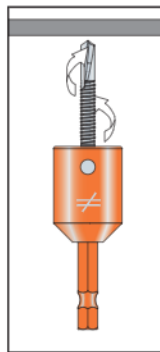
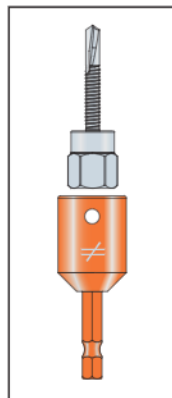

\* See p. 12 for an explanation of the load table icons.