



Rigid Nonmetallic Conduit – Conduit Bodies



LISTED LR31146
 E42728
 Except where noted by ▶

Conduit Bodies

- Hubs are not threaded
- Textured lids
- Foam-in-place gasket

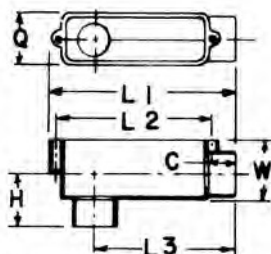
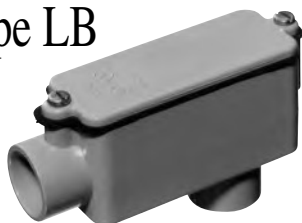
Type LB



Part No.	Size	Std. Ctn. Qty.	C Typical	Max. L1	L2 Typical	L3	Max H	Max Q	Max. W	Vol. Cu. In.
E986D	1/2	25	11/16	4 5/16	3 7/32	3 1/16	1 5/16	1 11/32	1 1/2	4.0
E986E	3/4	15	29/32	6 9/32	5 9/32	4 25/32	1 25/32	1 3/4	2 1/32	12.0
E986F	1	10	29/32	6 9/32	5 9/32	4 25/32	1 25/32	1 3/4	2 1/32	12.0
E986G	1 1/4	10	1 3/32	7 31/32	6 13/32	6	2 5/16	2 1/2	2 3/4	32.0
E986H	1 1/2	10	1 3/32	7 31/32	6 13/32	6	2 5/16	2 1/2	2 3/4	32.0
E986J	2	10	1 5/32	9 31/32	8 13/32	7 1/4	2 9/16	3 5/32	3 15/32	63.0
▶ E986K	2 1/2	4	1 5/8	14 7/8	13 1/4	11 31/32	3 3/4	4 11/32	4 5/8	210.
▶ E986L	3	4	1 5/8	14 7/8	13 1/4	11 31/32	3 3/4	4 11/32	4 5/8	210.
▶ E986M	3 1/2	4	1 25/32	17 23/32	15 7/8	14 17/64	4 7/16	5 11/32	5 21/32	390.
▶ E986N	4	4	1 25/32	17 23/32	15 7/8	14 17/64	4 7/16	5 11/32	5 21/32	390.

Type LR

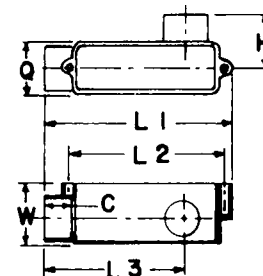
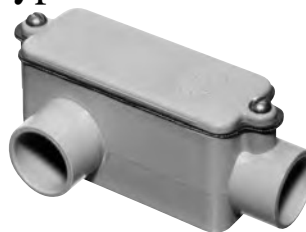

Part No.	Size	Std. Ctn. Qty.	C Typical	Max. L1	L2 Typical	L3	Max H	Max Q	Max. W	Vol. Cu. In.
E985D-CAR	1/2	10	11/16	4 5/16	3 7/32	3 1/16	1 5/16	1 11/32	1 1/2	4.0
E985E-CAR	3/4	10	29/32	6 9/32	5 9/32	4 25/32	1 25/32	1 3/4	2 1/32	12.0
E985F	1	10	29/32	6 9/32	5 9/32	4 25/32	1 25/32	1 3/4	2 1/32	12.0
E985G	1 1/4	10	1 3/32	7 31/32	6 13/32	6	2 5/16	2 1/2	2 3/4	32.0
E985H-CAR	1 1/2	5	1 3/32	7 31/32	6 13/32	6	2 5/16	2 1/2	2 3/4	32.0
E985J	2	10	1 5/32	9 31/32	8 13/32	7 1/4	2 9/16	3 5/32	3 15/32	63.0

Type E

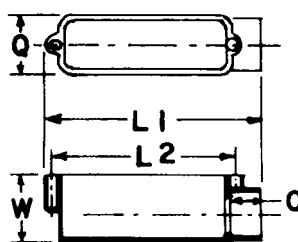
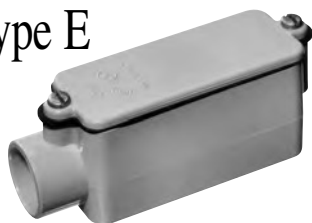

Part No.	Size	Std. Ctn. Qty.	C	L1	L2	Q	W	Vol. Cu. In.
E988D	1/2	25	11/16	4 5/16	3 1/2	1 11/32	1 1/2	4.0
E988E	3/4	20	29/32	6 11/32	5 9/32	1 3/4	2 1/32	12.0
E988F	1	10	29/32	6 11/32	5 9/32	1 3/4	2 1/32	12.0
E988G	1 1/4	10	1 3/32	8	6 13/32	2 1/2	2 3/4	32.0
E988H	1 1/2	10	1 3/32	8	6 13/32	2 1/2	2 3/4	32.0
E988J	2	5	1 5/32	9 15/32	8 13/32	3 5/32	3 15/32	63.0

Type T

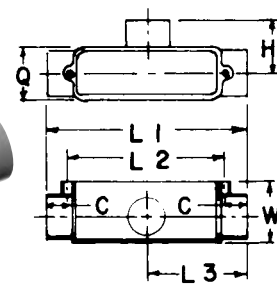

Part No.	Size	Std. Ctn. Qty.	C Typical	Max. L1	L2 Typical	L3	Max H	Max Q	Max. W	Vol. Cu. In.
E983D-CAR	1/2	10	11/16	4 11/16	3 7/32	2 11/32	1 5/16	1 11/32	1 1/2	4.0
E983E	3/4	15	29/32	6 7/8	5 9/32	4 7/16	1 25/32	1 3/4	2 1/32	12.0
E983F	1	20	29/32	6 7/8	5 9/32	3 7/16	1 25/32	1 3/4	2 1/32	12.0
E983G	1 1/4	10	1 3/32	8 21/32	6 13/32	4 21/64	2 5/16	2 1/2	2 3/4	32.0
E983H	1 1/2	10	1 3/32	8 21/32	6 13/32	4 21/64	2 5/16	2 1/2	2 3/4	32.0
E983J	2	10	1 5/32	10 5/16	8 13/32	5 5/32	2 9/16	3 5/32	3 15/16	63.0

Type C

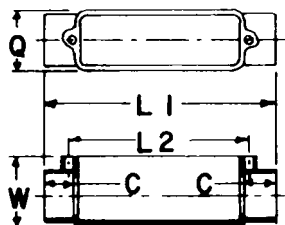
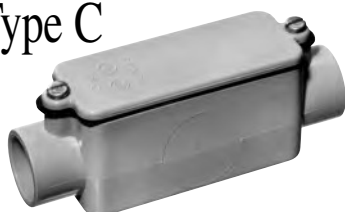

Part No.	Size	Std. Ctn. Qty.	C Typical	Max. L1	L2 Typical	Max Q	Max. W	Vol. Cu. In.
E987D	1/2	25	11/16	4 11/16	3 1/2	1 11/32	1 1/2	4.0
E987E-CAR	3/4	10	29/32	6 7/8	5 32/64	1 3/4	2 1/32	12.0
E987F-CAR	1	10	29/32	6 7/8	5 9/32	1 3/4	2 1/32	12.0
E987G	1 1/4	10	1 3/32	8 21/32	6 13/32	2 1/2	2 3/4	32.0
E987H	1 1/2	10	1 3/32	8 21/32	6 13/32	2 1/2	2 3/4	32.0
E987J	2	15	1 5/32	10 5/16	8 13/32	3 5/32	3 15/32	63.0

Type LL

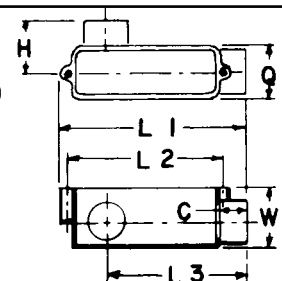
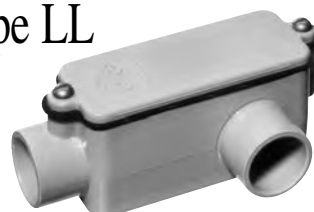

Part No.	Size	Std. Ctn. Qty.	C Typical	Max. L1	L2 Typical	L3	Max H	Max Q	Max. W	Vol. Cu. In.
E984D-CAR	1/2	10	11/16	4 5/16	3 7/32	3 1/16	1 5/16	1 11/32	1 1/2	4.0
E984E	3/4	20	29/32	6 9/32	5 9/32	4 25/32	1 25/32	1 3/4	2 1/32	12.0
E984F-CAR	1	10	29/32	6 9/32	5 9/32	4 25/32	1 25/32	1 3/4	2 1/32	12.0
E984G-CAR	1 1/4	5	1 3/32	7 31/32	6 13/32	6	2 5/16	2 1/2	2 3/4	32.0
E984H	1 1/2	10	1 3/32	7 31/32	6 13/32	6	2 5/16	2 1/2	2 3/4	32.0
E984J	2	10	1 5/32	9 31/32	8 13/32	7 1/4	2 9/16	3 5/32	3 15/32	63.0