



Rigid Nonmetallic Conduit – Conduit Bodies



LISTED LR31146
 E42728
 Except where noted by ▶

Conduit Bodies

- Hubs are not threaded
- Textured lids
- Foam-in-place gasket

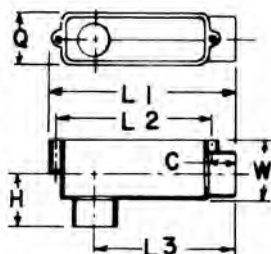
Type LB



| Part No. | Size | Std. Ctn. Qty. | C Typical | Max. L1 | L2 Typical | L3 | Max H | Max Q | Max. W | Vol. Cu. In. |
|----------|-------|----------------|-----------|----------|------------|----------|---------|---------|---------|--------------|
| E986D | 1/2 | 25 | 11/16 | 4 5/16 | 3 7/32 | 3 1/16 | 1 5/16 | 1 11/32 | 1 1/2 | 4.0 |
| E986E | 3/4 | 15 | 29/32 | 6 9/32 | 5 9/32 | 4 25/32 | 1 25/32 | 1 3/4 | 2 1/32 | 12.0 |
| E986F | 1 | 10 | 29/32 | 6 9/32 | 5 9/32 | 4 25/32 | 1 25/32 | 1 3/4 | 2 1/32 | 12.0 |
| E986G | 1 1/4 | 10 | 1 3/32 | 7 31/32 | 6 13/32 | 6 | 2 5/16 | 2 1/2 | 2 3/4 | 32.0 |
| E986H | 1 1/2 | 10 | 1 3/32 | 7 31/32 | 6 13/32 | 6 | 2 5/16 | 2 1/2 | 2 3/4 | 32.0 |
| E986J | 2 | 10 | 1 5/32 | 9 31/32 | 8 13/32 | 7 1/4 | 2 9/16 | 3 5/32 | 3 15/32 | 63.0 |
| ▶ E986K | 2 1/2 | 4 | 1 5/8 | 14 7/8 | 13 1/4 | 11 31/32 | 3 3/4 | 4 11/32 | 4 5/8 | 210. |
| ▶ E986L | 3 | 4 | 1 5/8 | 14 7/8 | 13 1/4 | 11 31/32 | 3 3/4 | 4 11/32 | 4 5/8 | 210. |
| ▶ E986M | 3 1/2 | 4 | 1 25/32 | 17 23/32 | 15 7/8 | 14 17/64 | 4 7/16 | 5 11/32 | 5 21/32 | 390. |
| ▶ E986N | 4 | 4 | 1 25/32 | 17 23/32 | 15 7/8 | 14 17/64 | 4 7/16 | 5 11/32 | 5 21/32 | 390. |

Type LR

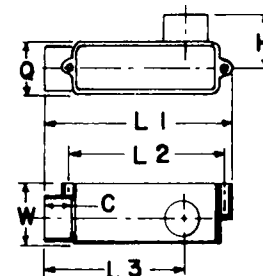
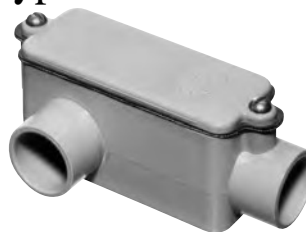

| Part No. | Size | Std. Ctn. Qty. | C Typical | Max. L1 | L2 Typical | L3 | Max H | Max Q | Max. W | Vol. Cu. In. |
|-----------|-------|----------------|-----------|---------|------------|---------|---------|---------|---------|--------------|
| E985D-CAR | 1/2 | 10 | 11/16 | 4 5/16 | 3 7/32 | 3 1/16 | 1 5/16 | 1 11/32 | 1 1/2 | 4.0 |
| E985E-CAR | 3/4 | 10 | 29/32 | 6 9/32 | 5 9/32 | 4 25/32 | 1 25/32 | 1 3/4 | 2 1/32 | 12.0 |
| E985F | 1 | 10 | 29/32 | 6 9/32 | 5 9/32 | 4 25/32 | 1 25/32 | 1 3/4 | 2 1/32 | 12.0 |
| E985G | 1 1/4 | 10 | 1 3/32 | 7 31/32 | 6 13/32 | 6 | 2 5/16 | 2 1/2 | 2 3/4 | 32.0 |
| E985H-CAR | 1 1/2 | 5 | 1 3/32 | 7 31/32 | 6 13/32 | 6 | 2 5/16 | 2 1/2 | 2 3/4 | 32.0 |
| E985J | 2 | 10 | 1 5/32 | 9 31/32 | 8 13/32 | 7 1/4 | 2 9/16 | 3 5/32 | 3 15/32 | 63.0 |

Type E

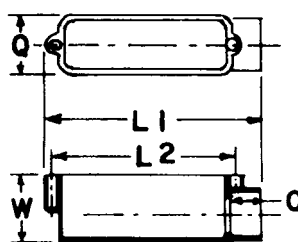
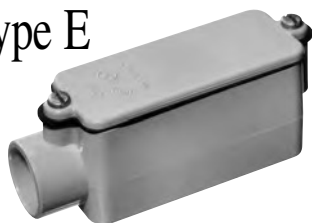

| Part No. | Size | Std. Ctn. Qty. | C | L1 | L2 | Q | W | Vol. Cu. In. |
|----------|-------|----------------|--------|---------|---------|---------|---------|--------------|
| E988D | 1/2 | 25 | 11/16 | 4 5/16 | 3 1/2 | 1 11/32 | 1 1/2 | 4.0 |
| E988E | 3/4 | 20 | 29/32 | 6 11/32 | 5 9/32 | 1 3/4 | 2 1/32 | 12.0 |
| E988F | 1 | 10 | 29/32 | 6 11/32 | 5 9/32 | 1 3/4 | 2 1/32 | 12.0 |
| E988G | 1 1/4 | 10 | 1 3/32 | 8 | 6 13/32 | 2 1/2 | 2 3/4 | 32.0 |
| E988H | 1 1/2 | 10 | 1 3/32 | 8 | 6 13/32 | 2 1/2 | 2 3/4 | 32.0 |
| E988J | 2 | 5 | 1 5/32 | 9 15/32 | 8 13/32 | 3 5/32 | 3 15/32 | 63.0 |

Type T

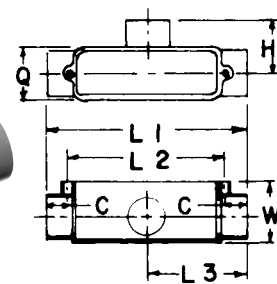

| Part No. | Size | Std. Ctn. Qty. | C Typical | Max. L1 | L2 Typical | L3 | Max H | Max Q | Max. W | Vol. Cu. In. |
|-----------|-------|----------------|-----------|---------|------------|---------|---------|---------|---------|--------------|
| E983D-CAR | 1/2 | 10 | 11/16 | 4 11/16 | 3 7/32 | 2 11/32 | 1 5/16 | 1 11/32 | 1 1/2 | 4.0 |
| E983E | 3/4 | 15 | 29/32 | 6 7/8 | 5 9/32 | 4 7/16 | 1 25/32 | 1 3/4 | 2 1/32 | 12.0 |
| E983F | 1 | 20 | 29/32 | 6 7/8 | 5 9/32 | 3 7/16 | 1 25/32 | 1 3/4 | 2 1/32 | 12.0 |
| E983G | 1 1/4 | 10 | 1 3/32 | 8 21/32 | 6 13/32 | 4 21/64 | 2 5/16 | 2 1/2 | 2 3/4 | 32.0 |
| E983H | 1 1/2 | 10 | 1 3/32 | 8 21/32 | 6 13/32 | 4 21/64 | 2 5/16 | 2 1/2 | 2 3/4 | 32.0 |
| E983J | 2 | 10 | 1 5/32 | 10 5/16 | 8 13/32 | 5 5/32 | 2 9/16 | 3 5/32 | 3 15/16 | 63.0 |

Type C

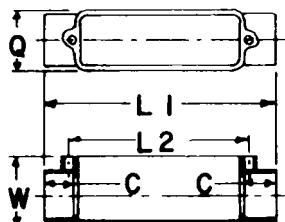
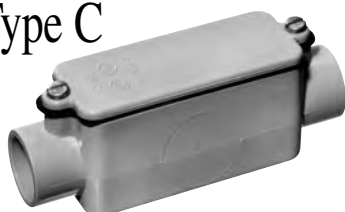

| Part No. | Size | Std. Ctn. Qty. | C Typical | Max. L1 | L2 Typical | Max Q | Max. W | Vol. Cu. In. |
|-----------|-------|----------------|-----------|---------|------------|---------|---------|--------------|
| E987D | 1/2 | 25 | 11/16 | 4 11/16 | 3 1/2 | 1 11/32 | 1 1/2 | 4.0 |
| E987E-CAR | 3/4 | 10 | 29/32 | 6 7/8 | 5 32/64 | 1 3/4 | 2 1/32 | 12.0 |
| E987F-CAR | 1 | 10 | 29/32 | 6 7/8 | 5 9/32 | 1 3/4 | 2 1/32 | 12.0 |
| E987G | 1 1/4 | 10 | 1 3/32 | 8 21/32 | 6 13/32 | 2 1/2 | 2 3/4 | 32.0 |
| E987H | 1 1/2 | 10 | 1 3/32 | 8 21/32 | 6 13/32 | 2 1/2 | 2 3/4 | 32.0 |
| E987J | 2 | 15 | 1 5/32 | 10 5/16 | 8 13/32 | 3 5/32 | 3 15/32 | 63.0 |

Type LL

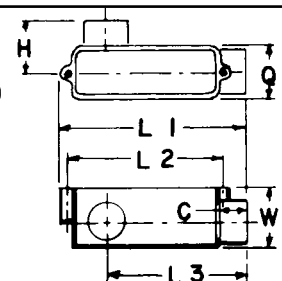

| Part No. | Size | Std. Ctn. Qty. | C Typical | Max. L1 | L2 Typical | L3 | Max H | Max Q | Max. W | Vol. Cu. In. |
|-----------|-------|----------------|-----------|---------|------------|---------|---------|---------|---------|--------------|
| E984D-CAR | 1/2 | 10 | 11/16 | 4 5/16 | 3 7/32 | 3 1/16 | 1 5/16 | 1 11/32 | 1 1/2 | 4.0 |
| E984E | 3/4 | 20 | 29/32 | 6 9/32 | 5 9/32 | 4 25/32 | 1 25/32 | 1 3/4 | 2 1/32 | 12.0 |
| E984F-CAR | 1 | 10 | 29/32 | 6 9/32 | 5 9/32 | 4 25/32 | 1 25/32 | 1 3/4 | 2 1/32 | 12.0 |
| E984G-CAR | 1 1/4 | 5 | 1 3/32 | 7 31/32 | 6 13/32 | 6 | 2 5/16 | 2 1/2 | 2 3/4 | 32.0 |
| E984H | 1 1/2 | 10 | 1 3/32 | 7 31/32 | 6 13/32 | 6 | 2 5/16 | 2 1/2 | 2 3/4 | 32.0 |
| E984J | 2 | 10 | 1 5/32 | 9 31/32 | 8 13/32 | 7 1/4 | 2 9/16 | 3 5/32 | 3 15/32 | 63.0 |