

## CR305X, CR385X auxiliary contact kits

### Field-installed modification kits

For 300-line starters

#### Auxiliary contact kits - basic blocks

NEMA Size	Contact Configuration	Block Design	Product Number
0,1	1NO	Basic	CR305X100A
0,1	1NC	Basic	CR305X100B
0,1	1NO-1NC	Basic	CR305X100C
2	1NO	Basic	CR305X200A
2	1NC	Basic	CR305X200B
2	1NO-1NC	Basic	CR305X200C
3,4	1NO	Basic	CR305X300A
3,4	1NC	Basic	CR305X300B
3,4	1NO-1NC	Basic	CR305X300C
5,6	1NO	Basic	CR305X500A
5,6	1NC	Basic	CR305X500B
5,6	1NO-1NC	Basic	CR305X500C
7	1NO	Basic	CR385X600A
7	1NC	Basic	CR385X600B
7	1NO-1NC	Basic	CR385X600C
8-9	1NO	Basic	CR385X800A
8-9	1NC	Basic	CR385X800B
8-9	1NO-1NC	Basic	CR385X800C

#### Auxiliary contact kits - adder blocks

NEMA Size	Contact Configuration	Block Design	Product Number
0-9	1NO	Adder	CR305X100D <sup>1</sup>
8-9	1NC	Adder	CR305X100E <sup>1</sup>

#### Logic reed switch auxiliary contacts<sup>2</sup>

NEMA Size	Contact Configuration	Product Number
00, 0, 1	1NO-0NC	CR305X100RA
00, 0, 1	0NO-1NC	CR305X100RB
00, 0, 1	1NO-1NC	CR305X100RC
2	1NO-0NC	CR305X200RA
2	0NO-1NC	CR305X200RB
2	1NO-1NC	CR305X200RC
3, 4	1NO-0NC	CR305X300RA
3, 4	0NO-1NC	CR305X300RB
3, 4	1NO-1NC	CR305X300RC
5, 6	1NO-0NC	CR305X500RA
5, 6	0NO-1NC	CR305X500RB
5, 6	1NO-1NC	CR305X500RC

#### Contact ratings - basic blocks

##### High fidelity contact basic block

120 VAC maximum .15 A maximum, 8 VA maximum resistive.

30 VDC maximum .15 A maximum, 4.5 VA maximum resistive.

##### Standard Block

AC Volts	Continuous Current Amperes	Inrush Current Amperes	DC Volts	Continuous Current Amperes	Inrush Current Amperes
115	6.0	60	125	1.1	—
230	3.0	30	250	0.5	—
460	1.5	15	—	—	—
575	1.2	12	—	—	—

<sup>1</sup>First adder block must be mounted to a basic block. A second adder block can be added to the first adder block on size 2 through size 9 starters.

Four extra auxiliary contacts (not blocks) is the maximum that can be added to either a NEMA size 0 or 1 starter while five is the maximum extra auxiliary contacts that can be added to NEMA Size 2 through 6 devices.

<sup>2</sup>CR305X logic reed switch auxiliary contacts may be ordered as a factory-installed modification. Order by description.

CR305X auxiliary contact kits

For field installation on magnetic starters (300-line)  
Selection and installation guides

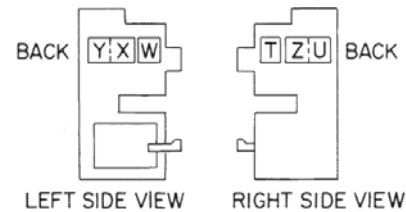

NEMA sizes 0 and 1, single-speed, nonreversing, 2- and 3-pole and starters (side views)

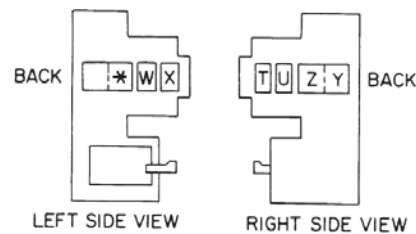

\* STANDARD HOLDING INTERLOCK  
NEMA sizes 2, 3 and 4, single-speed, nonreversing, starters (side views)

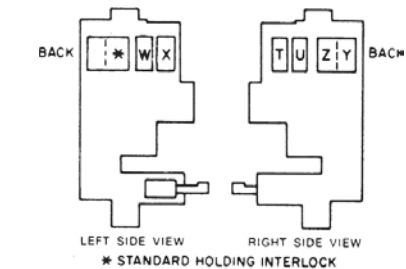

NEMA sizes 5 and 6 single-speed, nonreversing, starters (side views)

Extra auxiliary contact table  
For NEMA size 0 and 1, AC coils only

Contact Location 5 Contacts Maximum						Kits for Field Modification Order in Quantities Shown Product Number CR305				
						X100A	X100B	X100C <sup>1</sup>	X100D	X100E
W	X	Y	T	Z	U	Basic Blocks			Adder Blocks	
	⊥					1				
	⊥	*					1			
	⊥	*						1		
⊥	⊥					1			1	
*	⊥	*						1		1
⊥	⊥	*						1		1
⊥	⊥	*						1		1
⊥	⊥			⊥		2			1	
*	⊥	*			*		2			1
⊥	⊥		⊥	⊥		2			2	
*	⊥	*	*		*		2			2
⊥	⊥	*		⊥	*			2		
⊥	⊥	*		⊥	*	1		1	1	
*	⊥	*			*		1	1		1

Extra auxiliary contact table  
For NEMA size 2, 3 and 4, AC coils only

Contact Location 5 Contacts Maximum						Kits for Field Modification Order in Quantities Shown Product Number CR305				
						For Size 2 X200A X200B X200C <sup>1</sup> X100D X100E				
						For Sizes 3, 4 X300A X300B X300C <sup>1</sup> X100D X100E				
W	X	Y	T	Z	U	Basic Blocks			Adder Blocks	
⊥									1	
*										1
		*	⊥				1			
⊥	⊥								2	
*	*									2
⊥		*	⊥				1		1	
⊥	⊥	*	⊥				1			1
*	⊥	*				1			2	
⊥	⊥	*					1			2
⊥	⊥	*	⊥			1	1		3	
*	⊥	*			*		1			3
*	⊥	*	⊥					1	1	1
⊥	⊥	*	⊥					1	2	
*	⊥	*	⊥					1		2
⊥	⊥	*	⊥					1	2	1
*	⊥	*	⊥		*			1	1	2
⊥	⊥	*	⊥		⊥			1	3	
*	⊥	*	⊥		*			1		3
⊥	⊥	*	⊥	⊥	⊥	1		1	4	
*	*	*		*	*		1			4

Extra auxiliary contact table

Contact Location 5 Contacts Maximum						Kits for Field Modification Order in Quantities Shown Product Number CR305				
						X500A	X500B	X500C <sup>1</sup>	X100D	X100E
W	X	Y	T	Z	U	Basic Blocks			Adder Blocks	
⊥									1	
*										1
		*	⊥					1		
⊥	⊥								2	
*	*									2
⊥		*	⊥					1	1	
⊥	⊥	*	⊥					1		1
*	⊥	*				1			2	
⊥	⊥	*					1			2
⊥	⊥	*	⊥						3	
*	⊥	*			*		1			3
*	⊥	*	⊥					1	1	1
⊥	⊥	*	⊥					1	2	
*	⊥	*	⊥					1		2
⊥	⊥	*	⊥					1	2	1
*	⊥	*	⊥		*			1	1	2
⊥	⊥	*	⊥		⊥			1	3	
*	⊥	*	⊥		*			1		3
⊥	⊥	*	⊥	⊥	⊥	1			4	
*	*	*		*	*		1			4

<sup>1</sup>Both NO and NC contacts must be wired for same polarity

## Field-installed modification kits

For 300-line starters

NEMA sizes 00-6



Selector switch kits



START-STOP push button kits

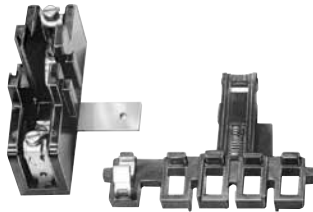

Fifth-pole kit

### Pilot device modification kits

The push button and selector switch kits listed here are supplied complete with the necessary components, hardware and written instructions for easy field installation on Type 1 enclosed starters—306.

Kit Type	NEMA Size	Product Number
Momentary Contact Start-Stop Push Button Kits	00, 0, 1	CR305X120N
Momentary Contact Start-Stop Push Button Kits	2	CR305X220N
Momentary Contact Start-Stop Push Button Kits	3, 4	CR305X320B
Momentary Contact Start-Stop Push Button Kits	5	CR305X520B
Hand-Off-Auto Selector Switch Kits	00, 0, 1	CR305X130N
Hand-Off-Auto Selector Switch Kits	2	CR305X230N
Hand-Off-Auto Selector Switch Kits	3, 4	CR305X330B
Hand-Off-Auto Selector Switch Kits	5	CR305X530B
Off-On Selector Switch Kits	00, 0, 1	CR305X130P
Off-On Selector Switch Kits	2	CR305X230D
Off-On Selector Switch Kits	3, 4	CR305X330D
Off-On Selector Switch Kits	5	CR305X530D

### Fifth-pole kits

To be installed on NEMA Size 0, 1, and 2 magnetic four-pole contactors and starters. Permits the addition of a fifth pole with the same rating as the main poles.

NEMA Size	Mounting Position	Product Number
0, 1	Right	CR305X111B
2 (add to 4-pole form)	Left	CR305X211B

### Adapter mounting plate

For mounting a 300-line magnetic starter in place of a competitive unit.

Adapter plate good for mounting in place of the following:

A-B 709. Size 1: W B200. Sizes 00-2: Furnas Sizes 00-1: GTE TM.

Sizes 00-2: Sq. D 8536, Sizes 00-2.

Not needed for C-H—same as ABB.

**Note:** GTE now known as Joslyn Clark.

NEMA Size	Product Number
0, 1	CR306X191A

### Indicating Light Kits (Red)

To be installed on contactor and extend through knockout in cover of CR305-306 and devices in Type 1 enclosures. Each kit has three resistors allowing light to be used with all voltages of 110 through 600. Uses NE-45 bulb. Can be used with push button or selector switch kit.

NEMA Size	Product Number
00, 0, 1	CR305X150N
2	CR305X250N
3, 4	CR305X350B
5	CR305X550B
NE-45 Bulb	CR2940U200BL