

# FITTINGS

Finish: Painted Green or Electro-galvanized Order By: No., Size and Finish

## PS 644 – Two-Hole Splice Clevis

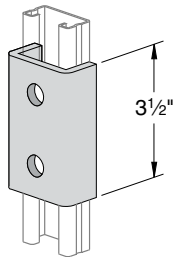

Use With: PS 500, PS 520 and PS 560

Weight/100 pcs: 85 lbs.

## PS 645 – Three-Hole Splice Clevis

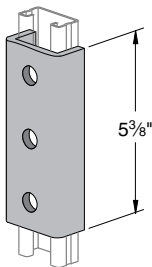

Use With: PS 500, PS 520 and PS 560

Weight/100 pcs: 130 lbs.

## PS 616, PS 646 – Four-Hole Splice Clevis

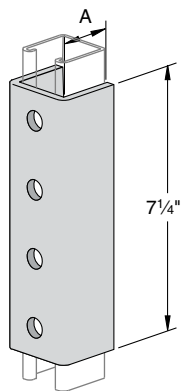

| Part No.   | A       | For Use With   | Wt./100 pcs |
|------------|---------|----------------|-------------|
| PS 616     | 1 9/16" | PS 200, PS 210 | 265         |
| PS 646     | 1 3/16" | PS 500, PS 560 | 176         |
| PS 616-100 | 3 3/16" | PS 100         | 390         |
| PS 616-150 | 2 3/8"  | PS 150         | 390         |

## PS 631 – Two-Hole Splice Clevis

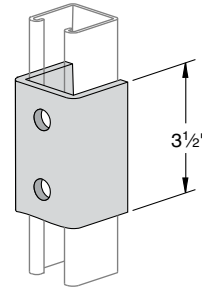

Use With: PS 200, PS 210

Weight/100 pcs: 128 lbs.

## PS 629 – Three-Hole Splice Clevis

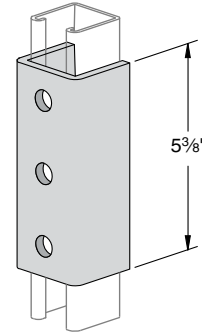

Use With: PS 200 and PS 210

Weight/100 pcs: 197 lbs.

## PS 623 – Saddle Washer

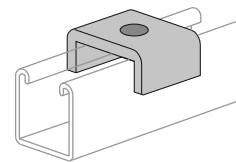

| Bolt Size | Wt./100 pcs |
|-----------|-------------|
| 1/4"      | 14          |
| 3/8"      | 14          |
| 1/2"      | 13          |
| 5/7"      | 13          |
| 3/4"      | 13          |

Weight/100 pcs: 265 lbs.