

Beam Clamp, C-Clamp Style, Malleable Iron, with Nut, Plain

This product standard contains the required dimensional, mechanical, performance, and chemical characteristics of the products shown in this purchase order (as applicable to the product). Unless specified below, current revisions of national or international standards shall be applicable as of the date of Fastenal's purchase order and must be adhered to in their entirety. If the order received does not meet these requirements, corrective action may be issued which could jeopardize your status as an approved supplier to Fastenal.

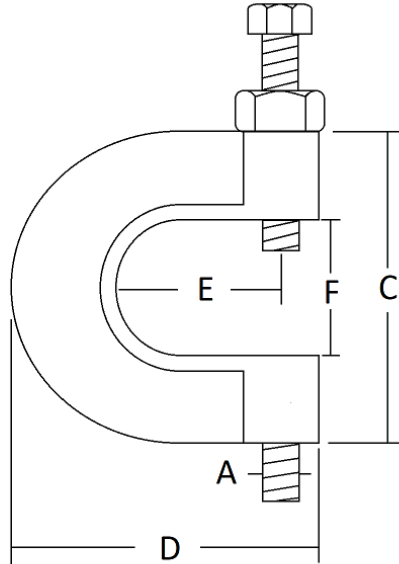

A	Set Screw	C	D	E	F	Max. Pipe Size	Maximum Recommended Load (lbs)
3/8	3/8-16	1.750	1.750	0.625	0.750	4	400
1/2	3/8-16	1.750	1.750	0.625	0.750	4	500
5/8	3/8-16	2.000	2.000	0.625	0.750	5	550
3/4	3/8-16	2.000	2.000	0.625	0.750	6	630

Specification Requirements:

- Dimensions: See dimensions above
Complies with Federal Specification WW-H-171-E (Type #23), A-A-1192 A (Type #23). MSS SP-58 Type 23
- Material: Malleable Iron in accordance with ASTM A47/A47M, Grade 32510
- Clamp Finish: Light Protective Oil

RECORD OF REVISION CHANGES TO THIS DOCUMENT ARE LOCATED ON THE LAST PAGE

Page 2 of 2	Fastenal Product Standard	REV-02
Date: April 13, 2020	<i>FASTENAL</i>	BC.CC.MI.WN.P

Revision Level Changes to this Document

Document Name	Revision Level	Revision Date	Rationale for Revision
BC.CC.MI.WN.P	02	4/13/2020	Revised image and material standard requirement.

The rationale above may not include all of the changes within each revision. A complete review of the Fastenal Product Standard is required.