

PS 626 – Pipe Stop

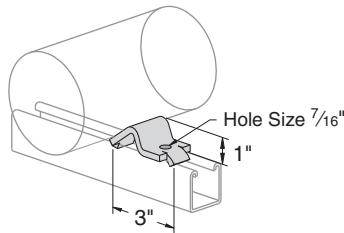

Clamp Requires bolt and channel nut sold separately.

Note: For use with 2" to 8" Pipe

Weight/100 pcs: 40 lbs.

PS 651 – Reversible Channel Bracket

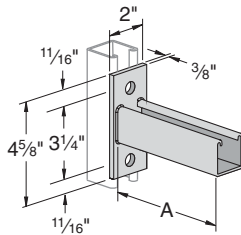

A Size	Uniform Load*	Wt./100 pcs
6"	1,200	185
12"	600	293
18"	400	401
24"	300	509
*Mounted on 12 Ga. Channel		

PS 708 – Single Channel Bracket Support

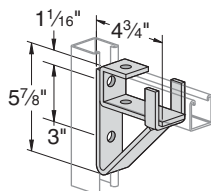

Use With: PS 200,
PS 210,
PS 500 2T3

Design Moment on Upright Channel:

- 16 ga. channel 3,200 in.-lbs.,
- 14 ga. channel 4,400 in.-lbs.
- 12 ga. channel 5,100 in.-lbs.

Note:

Moment is for fitting only.
Channel may determine overall capacity.

Weight/100 pcs: 235 lbs.

PS 661 T1, PS 661 T2 – Wrap-Around Channel Bracket

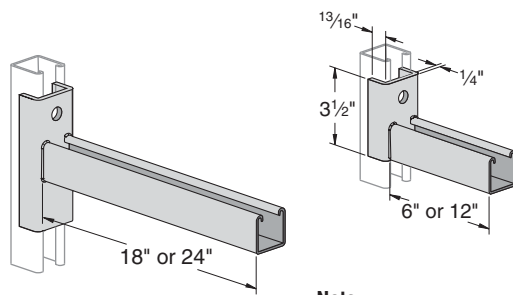

Note:
PS 661 T1 (Slot up) illustrated
PS 661 T2 (Slot down) not shown

Size	Uniform Load*	Wt./100 pcs
6"	1,600	191
12"	800	292
18"	600	436
24"	450	536
*Mounted on 12 Ga. Channel		



Fittings

PS 808 T1, PS 808 T2 – Interlocking Channel Bracket

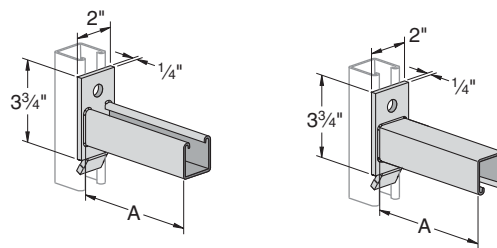

(PS 808 T1 - Slot Up)

(PS 808 T2 - Slot Down)

A Size	Uniform Load*	Wt./100 pcs
6"	1,200	161
12"	600	261
18"	400	361
24"	300	461
*Mounted on 12 Ga. Channel		

PS 809 – Double Channel Bracket

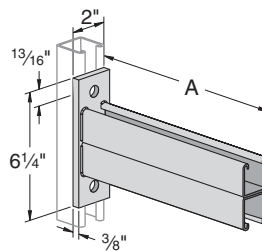

A Size	Uniform Load*	Wt./100 pcs
12"	2,000	502
18"	1,300	692
24"	1,000	882
30"	800	1,072
36"	650	1,262
*Mounted on 12 Ga. Channel		

PS 732 – Shelf Bracket

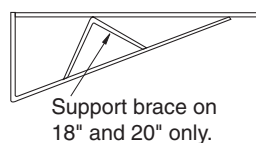
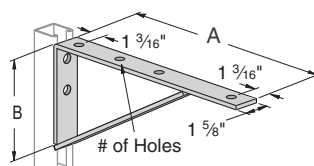

Size	A	B	# of Holes	Uniform Load*	Wt./100 pcs
8"	8 1/2"	4"	2	800	168
10"	10 1/2"		3		202
12"	12 1/2"	6"	4	900	258
14"	14 1/2"		4		292
16"	16 1/2"		4		1,200
18"	18 1/2"		4	416	
20"	20 1/2"		4	461	
*Mounted on 12 ga. channel					