

# EMT and Rigid Combination Conduit Bodies with Covers and Gaskets

## TB Type

### Features

- Combination TB type with cover and gasket
- NPT tapered hubs
- Suitable for use in concrete
- NEMA FB 1 rated for wet locations use with threaded rigid metal conduit only

### Applications

- Provides access to conductors for pulling, splicing and maintenance

### Standard Material

- Copper free aluminum die cast
- Cover - Stamped steel
- Gasket - Neoprene rubber

### Standard Finish

- Powder coat

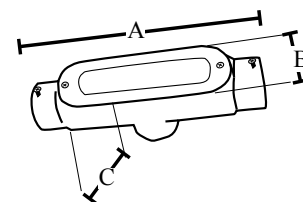

Catalog Number	UPC	Size	Max. Number	Max. Size	Unit Carton	Ship Case	Weight/Case	Inches		
								A	B	C
<b>TB1SSCG</b>	17572	<b>1/2"</b>	1	6 AWG	10	100	38	5.35	1.31	2.02
<b>TB2SSCG</b>	17573	<b>3/4"</b>	2	6 AWG	10	50	30	6.00	1.62	2.22
<b>TB3SSCG</b>	17574	<b>1"</b>	3	6 AWG	5	25	18	7.06	1.88	2.56
<b>TB4SSCG</b>	17575	<b>1-1/4"</b>	3	2 AWG	2	10	17	7.25	2.50	3.50
<b>TB5SSCG</b>	17576	<b>1-1/2"</b>	3	2 AWG	2	10	19	9.25	2.67	3.50
<b>TB6SSCG</b>	17577	<b>2"</b>	3	2/0 AWG	---	5	14	11.50	3.29	4.25