

Type RWA

Reduced Wall Flexible Aluminum
UL Listed Flexible Metal Conduit (FMC)



Construction

- Constructed of continuously interlocked aluminum strip.
- Flexible with high crush resistance.
- Superior corrosion resistance.
- Smooth exterior and interior allow easy pulling and wire fishing.

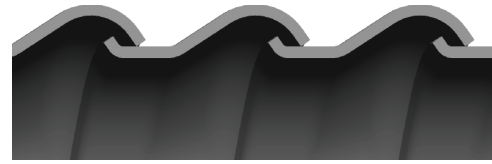

Angle-Lock Design 3/8" through 4"

Installation

- Uses standard flexible metal conduit fittings giving an IP40 rating.
- Light weight, easy to cut.
- UL Listed Standard #1, File # E98045.
- Manufactured in size range from 3/8" through 4".
- Complies with Article 348, NEC.
- NEMA 1 Enclosure.
- Permitted to be used in exposed and concealed locations (Article 348.10); enclosed motor leads (Article 430.245(B)); elevators, escalators, wheelchair lifts (Article 620.21). Not for wet locations.
- +500°F Maximum temperature.

NEC Articles

- Article 250.102, 250.118(5) and 250.134(B) Equipment Grounding.
- Article 300.22 (D) Information Technology Equipment
- Article 348 Flexible Metal Conduit. (FMC)
- Article 501.30 (B) Class I Div. 2.
- Article 620.21 Elevator Wiring Methods
- Article 645.5 (E) (2) Under Raised Floors

www.ul.com
www.nema.org

www.naed.org
www.anametelectrical.com

• UL LISTED  • RoHS WEEE COMPLIANT

Type RWA

Flexible aluminum conduit

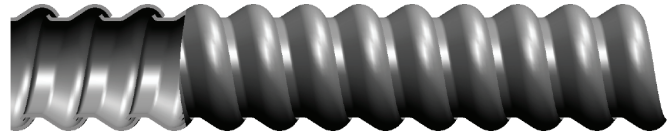

Product Specifications

Ordering Information

Electrical Trade Size		Inside Diameter		Outside Diameter		Approx Inside Bend Radius	Approx Weight lbs.	Standard Coils		Standard Reels		Additional Packaging	
Inches	mm	Inches		Inches				Inches	PER 100 FT.	Length Feet	NAED PIN	Length Feet	NAED PIN
		MIN.	MAX.	MIN.	MAX.								
3/8	12	.375	.393	.560	.610	2	6.5	100	441503	1000	441507	500	441506
1/2	16	.625	.645	.860	.920	3	9.5	100	441513	1000	441517	500	441516
3/4	21	.812	.835	1.045	1.105	4	12.5	100	441523	500	441526	1000	441527
1	27	1.000	1.040	1.300	1.380	5	18	50	441532	300	441533		
1-1/4	35	1.250	1.300	1.550	1.630	6-1/4	22	50	441542	200	441547		
1-1/2	41	1.500	1.575	1.850	1.950	7-1/2	26	25	441551	150	441553		
2	53	2.000	2.080	2.350	2.450	10	35	25	441561	100	441562		
2-1/2	63	2.500		2.860	3.060	12-1/2	57	25	441571				
3	78	3.000		3.360	3.560	15	68	25	441581				
3-1/2	91	3.500		3.860	4.060	17-1/2	80	25	441601				
4	103	4.000		4.360	4.560	20	91	25	441591				

Note: 1. Additional put-ups available.

TYPICAL SPECIFICATION:

Conduit shall be Anaconda Type RWA flexible reduced wall aluminum conduit and be made of continuously interlocked aluminum strip.
Conduit shall be UL listed in electrical trade sizes 3/8" thru 4".