

## STRAIGHT BLADE RECEPTACLES

## PlugTail® Specification Grade Receptacles

PTTR5362W and PT5362SCI  
PlugTail® Spec Grade Receptacles

- A. Auto-ground clip** assures positive ground.
  - B. .036 inch thick, brass, triple-wipe power contacts** for lasting retention.
  - C. Dual mechanical shutter system** to help prevent insertion of foreign objects.
  - D. Plated steel wrap strap design** for maximum durability and corrosion resistance.
  - E. Built-in connector** features large brass terminal blades to ensure consistent, reliable electrical connections.
  - F. Large brass contacts** snugly terminate on device blade terminals. Audible snapping latch assures connection, allows release.
  - G. Ultrasonically welded polycarbonate connector housing** secures terminations and conductors in a UL Listed, finger safe housing.
  - H. Pre-stripped connector leads** fasten to conductors, easier than standard pigtails.
  - I. No exposed terminals** create a finger safe application before, during, and after installation.
  - J. Built-in connector** features large brass terminal blades to ensure consistent, reliable electrical connections.
  - K. Large brass contacts** snugly terminate on device blade terminals. Audible snapping latch assures connection, allows release.
  - L. Exclusive patented feature, circuit label on back** allows permanent circuit identification.
  - M. Ultrasonically welded polycarbonate connector housing** secures terminations and conductors in a UL Listed, finger safe housing.
  - N. Pre-stripped connector leads** fasten to conductors, easier than standard pigtails.
  - O. Auto-ground clip** assures positive ground.
  - P. .036 inch thick, brass, triple-wipe power contacts** for lasting retention.
  - Q. Plated steel wrap strap design** for maximum durability and corrosion resistance.
  - R. Pre-wired with one welded pre-stripped wire lead** to facilitate switched receptacle circuit applications.
- Three drive screws anchor strap** to back body and face.

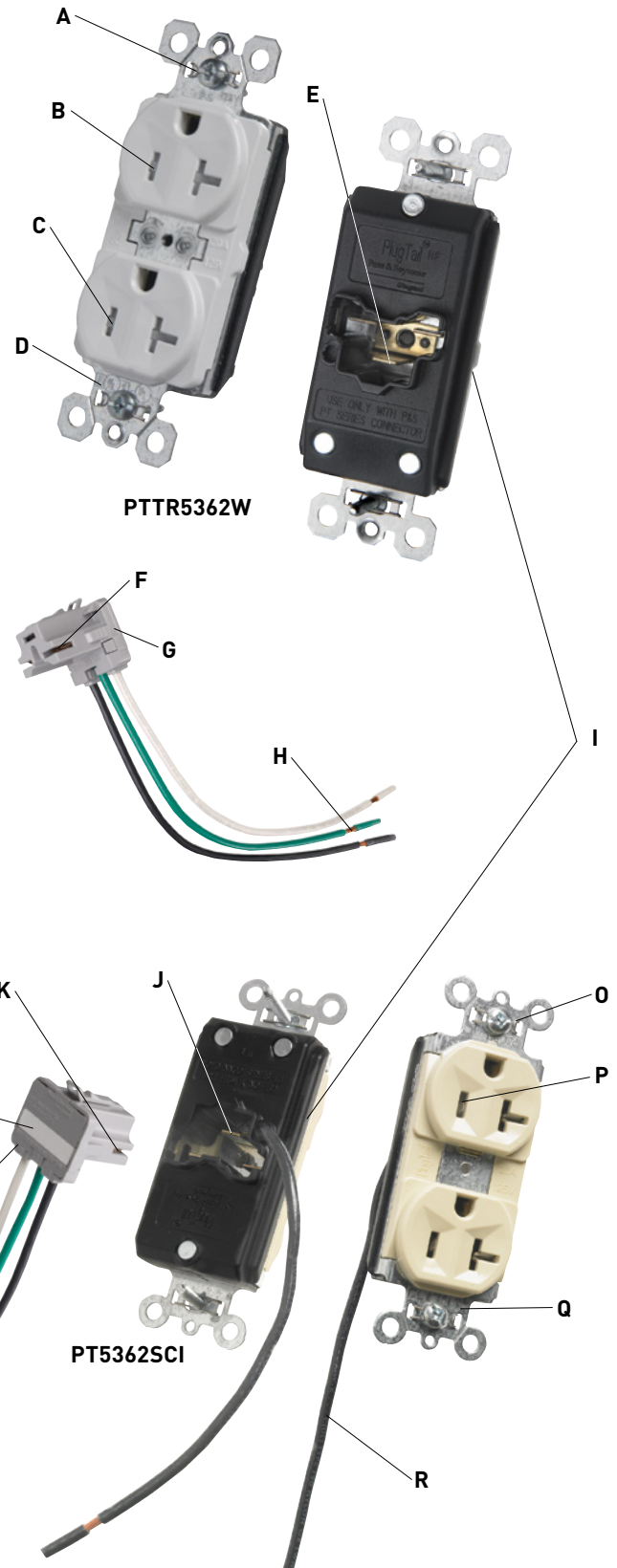

# STRAIGHT BLADE RECEPTACLES

## PlugTail® Tamper-Resistant Specification & Hospital Grade Receptacles 15 & 20A, 125V

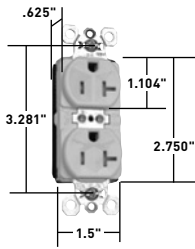

**PTTR5362W**

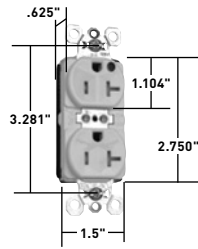

**PTTR8300W**

### Features

- Dual mechanical shutter system to help prevent insertion of foreign objects.
- .036 inch thick, brass, triple-wipe power contacts for lasting retention.
- Plated steel wrap-around strap design for maximum durability and corrosion resistance.
- No exposed terminals create a finger safe application before, during, and after installation.
- Built-in connector features large brass terminal blades to ensure consistent, reliable electrical connections.
- Crimped and welded contacts.
- Ultrasonically welded polycarbonate connector housing secures terminations and conductors in a UL Listed, finger safe housing.
- Large brass contacts snugly terminate on device blade terminals.
- Pre-stripped connector leads fasten to conductors, easier than standard pigtails.
- Auto-ground clip assures positive ground.

CATALOG NUMBER	RATING		COLOR	NEMA CONFIG. NO.	3rd PARTY COMPLIANCE	
	A.	V.			cUL <sup>us</sup> UL498	FSUL WC596
<b>DUPLEX RECEPTACLES</b>						
PTTR5262I	15	125	Ivory	5-15R	•	•
PTTR5262W	15	125	White	5-15R	•	•
PTTR5262	15	125	Brown	5-15R	•	•
PTTR5262GRY	15	125	Gray	5-15R	•	•
PTTR5262RED	15	125	Red	5-15R	•	•
PTTR5262LA	15	125	Light Almond	5-15R	•	•
PTTR5362I	20	125	Ivory	5-20R	•	•
PTTR5362W	20	125	White	5-20R	•	•
PTTR5362	20	125	Brown	5-20R	•	•
PTTR5362GRY	20	125	Gray	5-20R	•	•
PTTR5362BK	20	125	Black	5-20R	•	•
PTTR5362LA	20	125	Light Almond	5-20R	•	•

CATALOG NUMBER	RATING		COLOR	NEMA CONFIG. NO.	3rd PARTY COMPLIANCE	
	A.	V.			cUL <sup>us</sup> UL498	FSUL WC596
<b>HOSPITAL GRADE DUPLEX RECEPTACLES</b>						
PTTR8200I	15	125	Ivory	5-15R	•	•
PTTR8200W	15	125	White	5-15R	•	•
PTTR8200RED	15	125	Red	5-15R	•	•
PTTR8300I	20	125	Ivory	5-20R	•	•
PTTR8300W	20	125	White	5-20R	•	•
PTTR8300	20	125	Brown	5-20R	•	•
PTTR8300GRY	20	125	Gray	5-20R	•	•
PTTR8300BK	20	125	Black	5-20R	•	•
PTTR8300RED	20	125	Red	5-20R	•	•
PTTR8300LA	20	125	Light Almond	5-20R	•	•

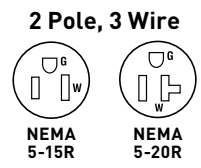

For Bulk Packaging Solutions consult factory.

All devices listed on this page conform to NEMA WD-1 and WD-6.

# DEVICES & WALL PLATES

## Color Selection Chart

### Devices & Plastic Wall Plate Colors

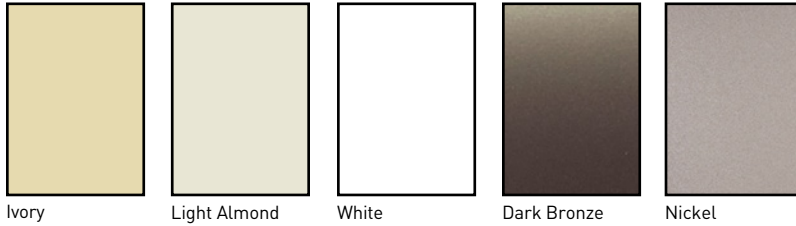

Ivory      Light Almond      White      Dark Bronze      Nickel

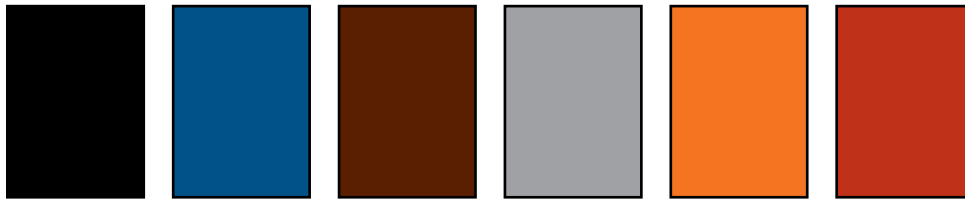

Black      Blue      Brown      Gray      Orange      Red

See specific device and wall plate catalog charts for particular color availabilities.

### Metal Wall Plates

Metal Finish



Aluminum      Polished Brass      Stainless Steel      Brushed Bronze      Chrome

### Custom Metal Wall Plates Paint Finish Colors

Paint Color

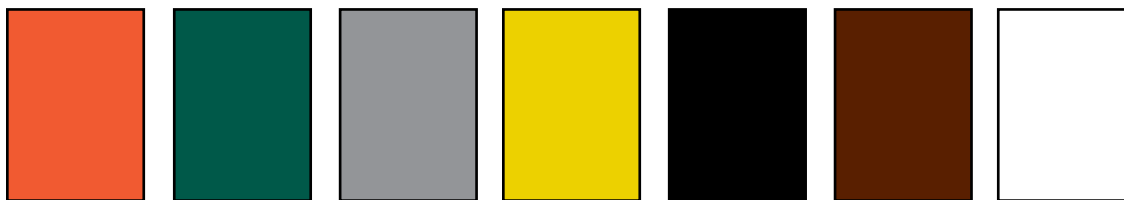

Orange      Green      Gray      Yellow      Glossy Black      Brown      White



Primer      Red      Pink      Flat Black      Ivory      Light Almond      Blue

To order custom metal wall plates, see Pages S-40 – S-44.

**For additional colors consult factory.**

STRAIGHT BLADE RECEPTACLES